

14/11

**South Lanarkshire Council
(Use of Off Street Parking Places)
Consolidation Order 2011, Amendment No. 7
Order 2013**

South Lanarkshire Council in exercise of the powers conferred on them by Sections 35(1) and (3), 3(A), 35A and 35B and Part IV of Schedule 9 of the Road Traffic Regulation Act 1984 ("the Act") and of all other enabling powers and after consultation with the Chief Constable of Police Scotland in accordance with Part III of Schedule 9 to the Act hereby make the following order:

1. This order may be cited as "South Lanarkshire Council (Use of Off-street Parking Places) Consolidation Order 2011, Amendment No. 7 Order 2013" and shall come into operation on the 10th day of March 2014.
2. The order specified in the schedule to this order shall have the effect subject to the amendments specified in that schedule.
3. Signed for and on behalf of South Lanarkshire Council by Colin McDowall, Executive Director, Community and Enterprise Resources, on the Thirteenth day of January Two Thousand and Fourteen.

Colin McDowall

SCHEDULE

In schedule 7 of the South Lanarkshire Council (Use of Off-street Parking Places) Consolidation Order 2011 add, in the form shown below:-

| <u>"Location of Parking Space within South Lanarkshire</u> | <u>Restriction on use</u> | <u>Scale of charges</u> |
|--|---------------------------|-------------------------|
|--|---------------------------|-------------------------|

| | | |
|--|--|--|
| <u>Carluke Leisure Centre car park, 135 Carnwath Road, Carluke</u> | | |
|--|--|--|

The area of land bounded on its north side by Carluke Leisure Centre, on its west side by a path leading to the Leisure centre, on its south side by a path and on its east side by a bus and parking area and shown crosshatched on map 250 annexed.

Maximum length of stay 3 hours, no return within 4 hours, Monday to Friday, 8am to 6pm, with the exception of vehicles displaying a valid "CLC" permit, or a valid disabled person's badge, who shall be permitted to park in the parking place referred to in column 1 opposite, without limit of time.

Nil

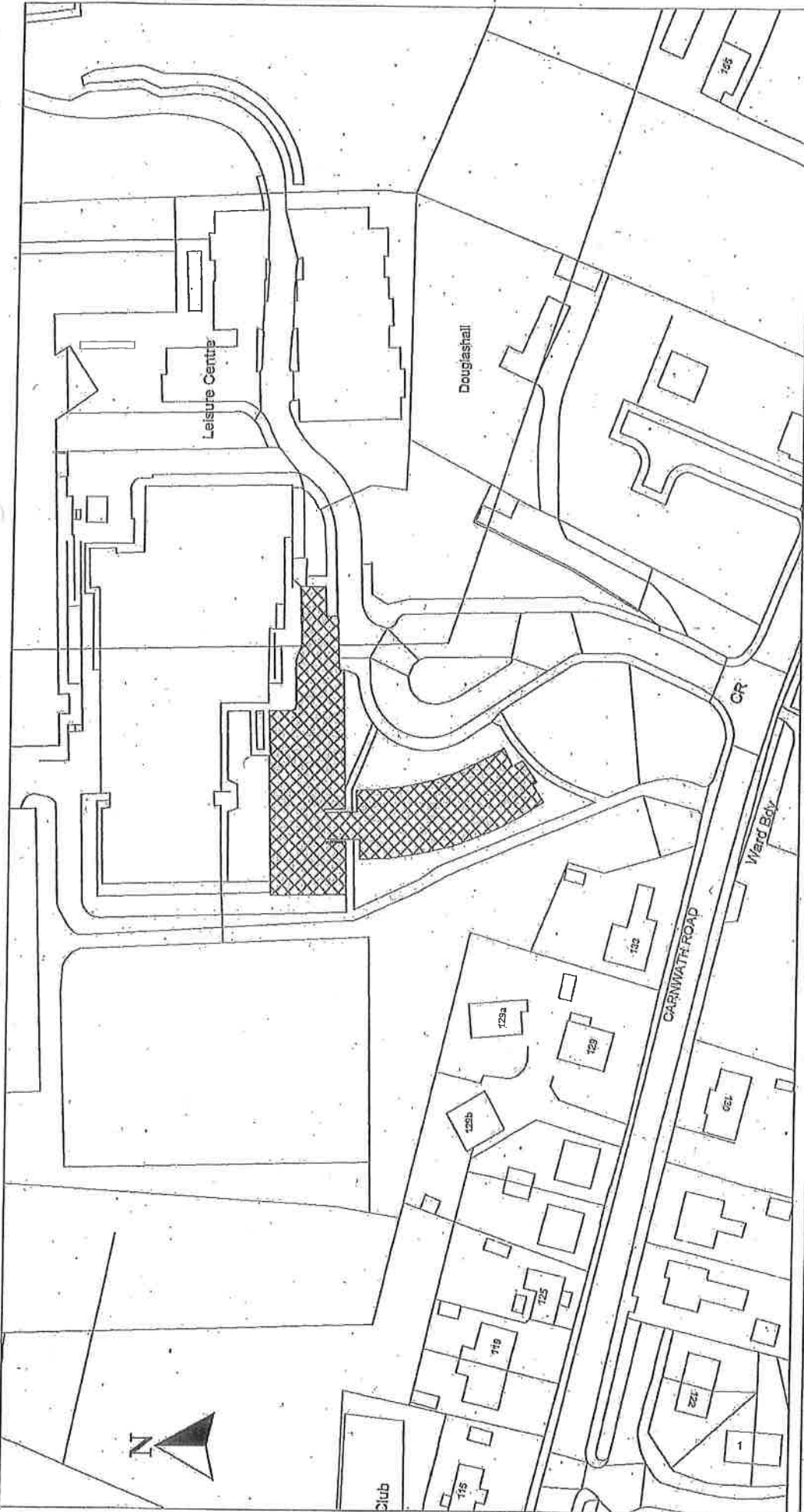

Map 250

**Carlisle Leisure Centre
135 Carmwath Road
Carlisle**

c Crown Copyright and database right 2013. All rights reserved. Ordnance Survey Licence number 100020730.
Licence No. 100020730

| | |
|-------------|----------------|
| SCALE | 1 : 1250 |
| DATE | 04/09/2013 |
| DRAWING No. | PUTRO/CO107/01 |
| DRAWN BY | S.H. |